

Freestanding Flex/Lab Building



CORNWELL TECHNOLOGY CENTER

SCOTTSDALE, ARIZONA

BUILDING A: 8515 EAST ANDERSON DRIVE | BUILDING B: 17301 NORTH PERIMETER DRIVE

FOR LEASE

For more information, please contact:

BRAD ANDERSON
Executive Vice President
602.735.1713
brad.anderson@cbre.com

BRYAN TAUTE
Senior Vice President
602.735.1710
bryan.taute@cbre.com

MIKE STRITTMATTER
Sales Assistant
602.735.5512
mike.strittmatter@cbre.com

CBRE

2415 East Camelback Road | Phoenix, Arizona 85016
T 602.735.5555 | F 602.735.5655 | www.cbre.com/phoenix



CORNWELL TECHNOLOGY CENTER

8515 East Anderson Drive, Building A
Scottsdale, Arizona

SPECIFICATIONS - FOR LEASE

TOTAL PROJECT SIZE:	Approximately 56,634 Square Feet
AVAILABILITY:	Building A: ±22,834 Rentable Square Feet
STARTING LEASE RATE:	\$14.00 Per Rentable Square Foot NNN
PARKING RATIOS:	4.60/1,000 SF
2012 ESTIMATED CAM:	\$4.40 Per Square Foot

BUILDING FEATURES

- Freestanding building
- Can accommodate flex, lab and office requirements
- Existing lab buildout
- Class "A" office buildout
- 12' ceilings
- Covered parking available

AREA HIGHLIGHTS

- Immediate access to Loop 101 (under 1/2 mile)
- Located within Scottsdale's Perimeter Center Business Park
- Quick access to Scottsdale Airport
- Nearby amenities include the Princess Resort, golf courses, hotels, retail and restaurants

BRAD ANDERSON
Executive Vice President
602.735.1713
brad.anderson@cbre.com

BRYAN TAUTE
Senior Vice President
602.735.1710
bryan.taute@cbre.com

MIKE STRITTMATTER
Sales Assistant
602.735.5512
mike.strittmatter@cbre.com

CBRE

2415 East Camelback Road
Phoenix, Arizona 85016-4290
T 602.735.5555 | F 602.735.5655
www.cbre.com/phoenix

This property is located in a flood zone.
© 2012 CBRE, Inc. This information has been obtained from sources believed reliable. We have not verified it and make no guarantee, warranty or representation about it. Any projections, opinions, assumptions or estimates used are for example only and do not represent the current or future performance of the property. You and your advisors should conduct a careful, independent investigation of the property to determine to your satisfaction the suitability of the property for your needs.

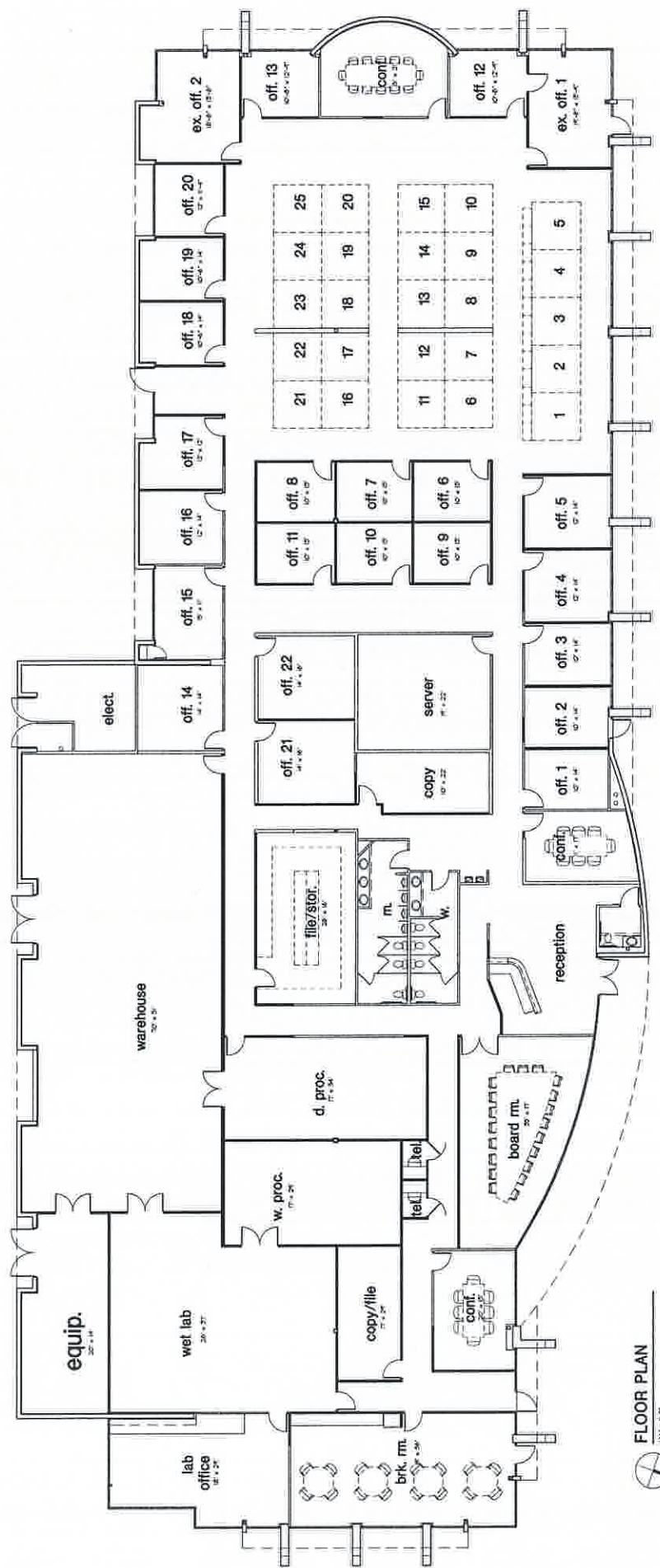

FLOOR PLAN
10.12.07